

RS3500 Vertical Cooler

Product Specifications

DESIGN HIGHLIGHTS

- Opening Speed Up To 48" Per Second
- 4" Panel Thickness – R17, with a Compressible Close Cell EVA Foam Core
- White Thermoplastic Flexible Panel Outer Shell
- Polyurethane Elastomer Perimeter Panel Edge
- Full Perimeter Adjustable Gasket Seals
- 3" Galvanized "Down and In" Track System
- 3" Nylon Rollers
- Counterbalancing Weight Assembly
- Manual Panel Release Capability
- Lift Handle
- NEMA 4X Panel with Self Diagnostic Controller with HMI Display and E-Stop Button Included
- Standard Open/Close/Stop through HMI
- Time Delay Closing
- (2) Sets of Through Beam Reversing Photo-Eyes
- Five-Year/One Million Cycle Limited Warranty on Mechanical Components and Door Controller
- Five-Year/Unlimited Cycle Warranty on EVA Foam Panels



Representative image only

4Front Engineered Solutions reserves the right to change specifications and designs without notice and without incurring obligations.

PROJECT INFORMATION

JOB NAME _____

ADDRESS _____

GENERAL CONTRACTOR _____

DISTRIBUTOR _____

MODEL _____ QUANTITY _____

CERTIFIED FOR CONSTRUCTION

BY _____

COMPANY _____

ADDRESS _____

DATE _____

CONTROLLER OPTIONS

- 460V - 3 PH
- 230V - 1 PH
- 230V/208V - 3 PH
- 575V - 3 PH
- NEMA 4X SS Control Box
- S/S Sloped Control Box

DOOR OPTIONS

- 6" Panel Thickness
- Chainfall
- Blue Panel Color
- _____" Other
- Slide Bolt
- 5"x22" Vision Panel
- Step Plate

ACTIVATION BOX

- Remote mounted push button NEMA 4X
- (2) remote mounted pull cord NEMA 4X
- (2) motion detectors
- (1) extended motion detector mounting bracket
- (1) loop detector
- Other _____

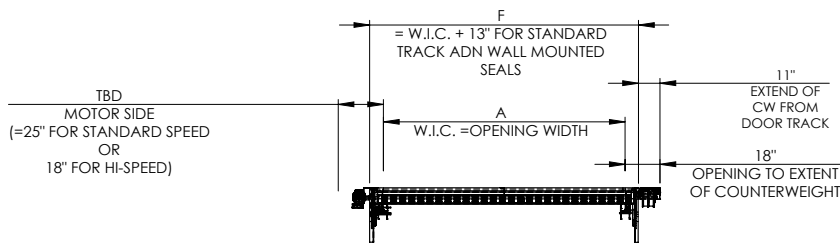

| | M | P |
|----------------|-----|-----|
| 4" PANEL (R17) | 14" | 12" |
| 6" PANEL (R25) | 16" | 14" |

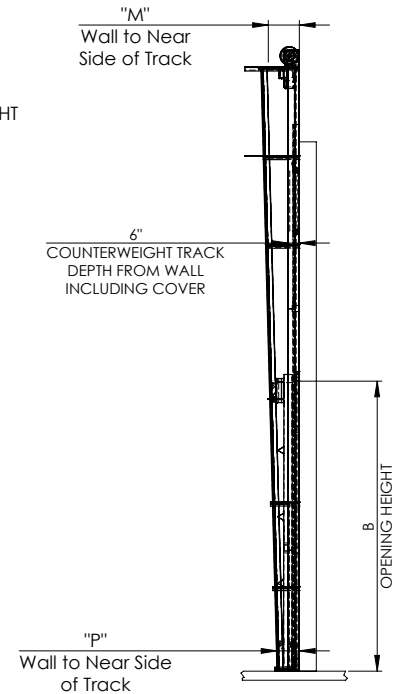
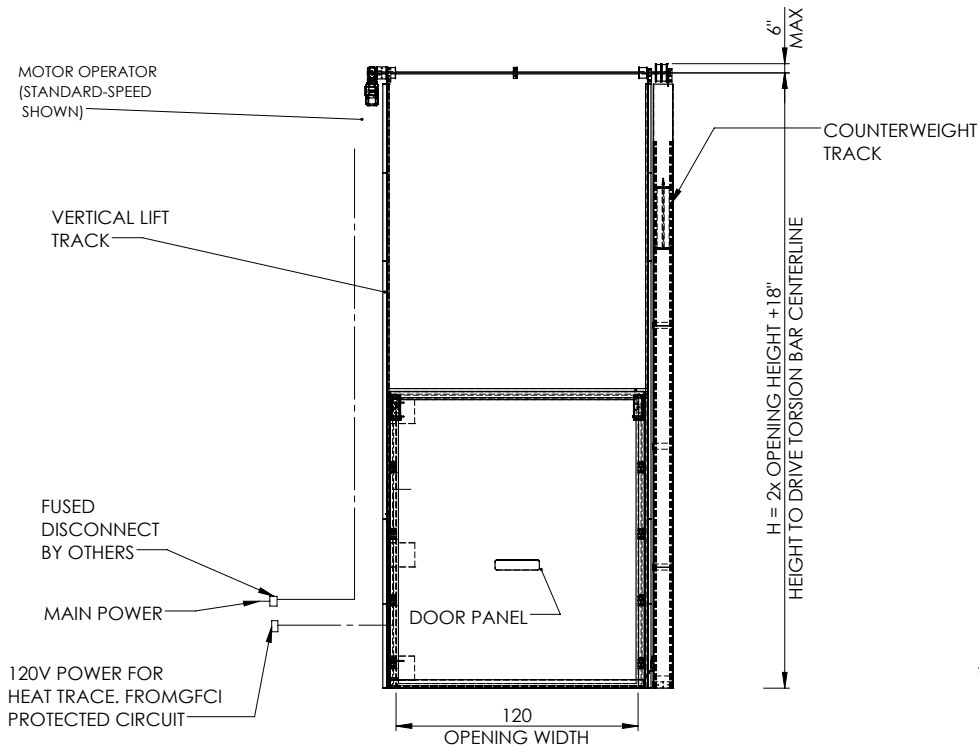

Albany
 13850 101st Street, Suite B
 Kenosha, WI 53142
 800.459.1930
 www.albanydoors.us

4Front Engineered Solutions reserves the right to change specifications and designs without notice and without incurring obligations. 4Front Engineered Solutions products may be the subject of one or more U.S. and/or foreign, issued and/or pending, design and/or utility patents. Serco as word and logo are registered trademarks belonging to ASSA ABLOY Entrance Systems AB or other companies controlled by the same organization. All rights reserved.